

STATE OF NORTH CAROLINA
DEPARTMENT OF TRANSPORTATION
HIGHWAY DIVISION 6

PLANS

Let Date: April 20, 2022

CONTRACT ID: DF00309

TIP NO.: -----

FEDERAL AID NO.: STATE FUNDED

WBS ELEMENT NO.: 2022CPT.06.17.20092.1 & 2022CPT.06.17.20092.2

ROUTE NO.: VARIOUS SR

LOCATION: VARIOUS

COUNTY: BLADEN

TYPE OF WORK: ASPHALT SURFACE TREATMENT – DOUBLE & TRIPLE SEALS

LENGTH OF PROJECT: 45.109 MILES

**This electronic collection of documents is provided
for the convenience of the user
and is Not a Certified Document –**

**The documents contained herein were originally issued
and sealed by the individuals whose names and license
numbers appear on each page, on the dates appearing
with their signature on that page.**

**This file or an individual page
shall not be considered a certified document.**

Date: 3/28/2022
 Contract #: DF00309
 WBS: Double Seals - 2022CPT.06.17.20092.1 (DF00309A)
 Triple Seals - 2022CPT.06.17.20092.2 (DF00309B)
 Division : 6
 County: Bladen
 Description: AST - Double & Triple Seals

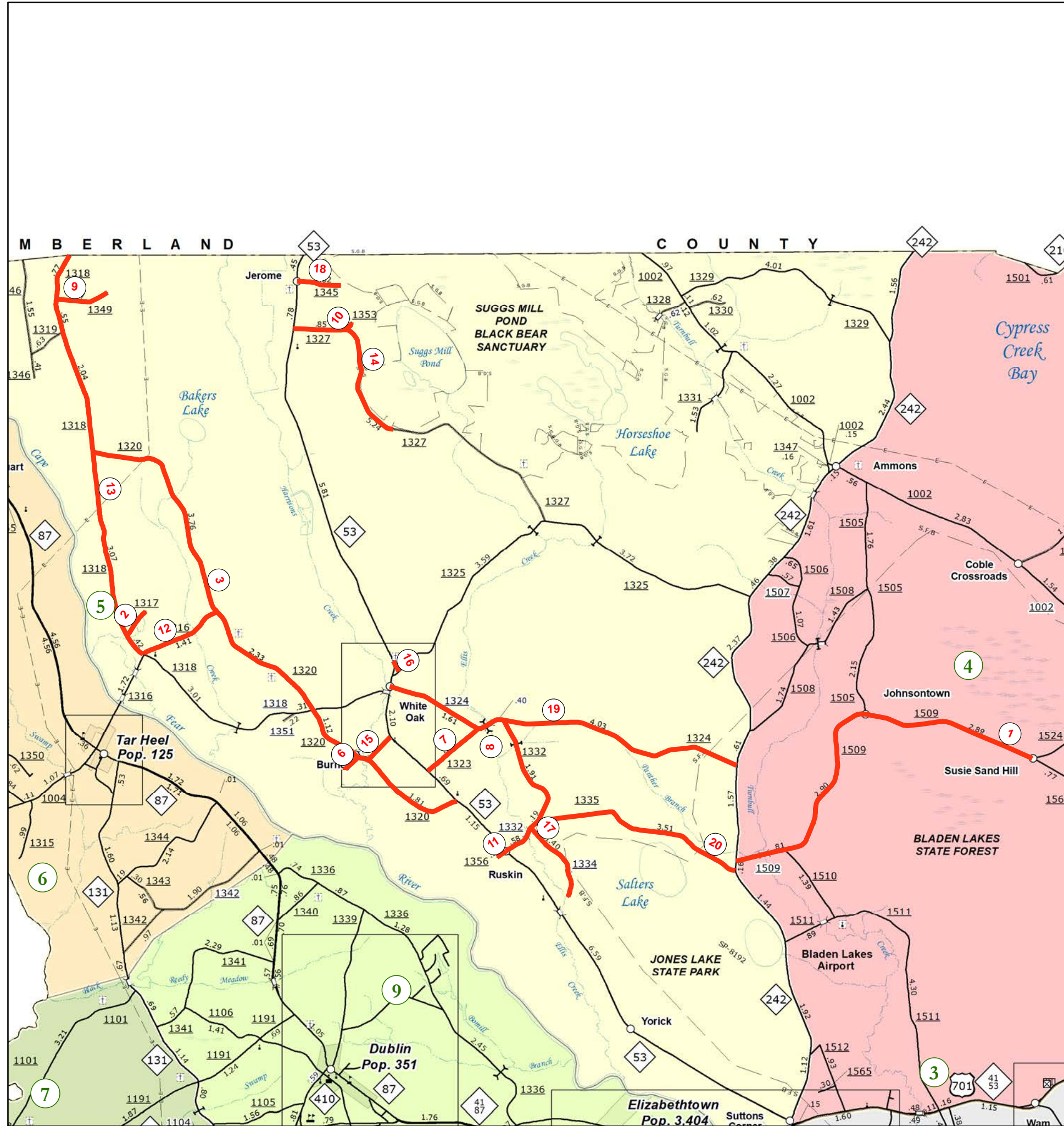

Map	Route	From	Begin MP	To	End MP	CL Length (Mile)	Width (Ft.)	Yardage (SY)	Treatment	Emulsion (GAL)	WZ Signs (SF)
1	SR 1509	SR 1524	3.74	NC 242	10.34	6.600	20	85,184	Double	46,851	426
2	SR 1317	SR 1318	0	CDS	0.5	0.500	18	5,808	Double	3,194	112
3	SR 1320	SR 1318	0	SR 1316	3.76	3.760	18	43,676	Double	24,022	267
4	SR 1320	SR 1316	3.76	SR 1318	6.09	2.330	24	36,087	Double	19,848	186
5	SR 1320	SR 1318	6.09	NC 53	9.196	3.106	20	40,088	Double	22,048	230
6	SR 1321	SR 1320	0	End Maint.	0.3	0.300	20	3,872	Double	2,130	112
7	SR 1323	NC 53	0	SR 1324	1.08	1.080	20	13,939	Double	7,666	112
8	SR 1332	NC 53	0	SR 1324	2.68	2.680	20	34,590	Double	19,025	206
9	SR 1349	SR 1318	0	Dead End	0.87	0.870	20	11,229	Double	6,176	84
10	SR 1353	SR 1327	0	Cul - De - Sac	0.16	0.160	20	2,065	Double	1,136	84
11	SR 1356	NC 53	0	End Pavement	0.18	0.180	20	2,323	Double	1,278	112
12	SR 1316	SR 1318	1.721	SR 1320	3.133	1.412	20	18,224	Double	10,023	112
13	SR 1318	SR 1316	4.62	Cumberland Co.	11.47	6.850	20	88,411	Double	48,626	440
14	SR 1327	Beg. Pvt	3.24	NC 53	6.09	2.850	20	36,784	Double	20,231	216
15	SR 1322	NC 53	0	SR 1320	0.52	0.520	20	6,711	Double	3,691	112
16	SR 1326	NC 53	0	SR 1325	0.19	0.190	18	2,207	Double	1,214	112
17	SR 1334	SR 1332	0	Dead End	1.4	1.400	20	18,069	Double	9,938	84
18	SR 1345	NC 53	0	Cul - De - Sac	0.721	0.721	20	9,306	Double	5,118	84
SUBTOTALS - DOUBLE SEALS:						35.509		458,573		252,215	3,091
19	SR 1324	NC 53	0	NC 242	6.09	6.09	20	78,602	Triple	61,310	397
20	SR 1335	NC 242	0	SR 1332	3.51	3.51	20	45,302	Triple	35,336	253
SUBTOTALS - TRIPLE SEALS:						9.600		123,904		96,646	650
TOTALS:						45.109		582,477		348,861	3,741

Schedule of Quantities

Date: 3/28/2022
 Contract #: DF00309
 WBS: Double Seals - 2022CPT.06.17.20092.1 (DF00309A)
 Triple Seals - 2022CPT.06.17.20092.2 (DF00309B)

Division : 6
 County: Bladen
 Description: AST - Double & Triple Seals

Map	Route	From	Begin MP	To	End MP	CL Length (Mile)	Width (Ft.)	Yardage (SY)	Treatment	Emulsion (GAL)	WZ Signs (SF)
1	SR 1509	SR 1524	3.74	NC 242	10.34	6.600	20	85,184	Double	46,851	426
2	SR 1317	SR 1318	0	CDS	0.5	0.500	18	5,808	Double	3,194	112
3	SR 1320	SR 1318	0	SR 1316	3.76	3.760	18	43,676	Double	24,022	267
4	SR 1320	SR 1316	3.76	SR 1318	6.09	2.330	24	36,087	Double	19,848	186
5	SR 1320	SR 1318	6.09	NC 53	9.196	3.106	20	40,088	Double	22,048	230
6	SR 1321	SR 1320	0	End Maint.	0.3	0.300	20	3,872	Double	2,130	112
7	SR 1323	NC 53	0	SR 1324	1.08	1.080	20	13,939	Double	7,666	112
8	SR 1332	NC 53	0	SR 1324	2.68	2.680	20	34,590	Double	19,025	206
9	SR 1349	SR 1318	0	Dead End	0.87	0.870	20	11,229	Double	6,176	84
10	SR 1353	SR 1327	0	Cul - De - Sac	0.16	0.160	20	2,065	Double	1,136	84
11	SR 1356	NC 53	0	End Pavement	0.18	0.180	20	2,323	Double	1,278	112
12	SR 1316	SR 1318	1.721	SR 1320	3.133	1.412	20	18,224	Double	10,023	112
13	SR 1318	SR 1316	4.62	Cumberland Co.	11.47	6.850	20	88,411	Double	48,626	440
14	SR 1327	Beg. Pvt	3.24	NC 53	6.09	2.850	20	36,784	Double	20,231	216
15	SR 1322	NC 53	0	SR 1320	0.52	0.520	20	6,711	Double	3,691	112
16	SR 1326	NC 53	0	SR 1325	0.19	0.190	18	2,207	Double	1,214	112
17	SR 1334	SR 1332	0	Dead End	1.4	1.400	20	18,069	Double	9,938	84
18	SR 1345	NC 53	0	Cul - De - Sac	0.721	0.721	20	9,306	Double	5,118	84
SUBTOTALS - DOUBLE SEALS:						35.509		458,573		252,215	3,091
19	SR 1324	NC 53	0	NC 242	6.09	6.09	20	78,602	Triple	61,310	397
20	SR 1335	NC 242	0	SR 1332	3.51	3.51	20	45,302	Triple	35,336	253
SUBTOTALS - TRIPLE SEALS:						9.600		123,904		96,646	650
TOTALS:						45.109		582,477		348,861	3,741

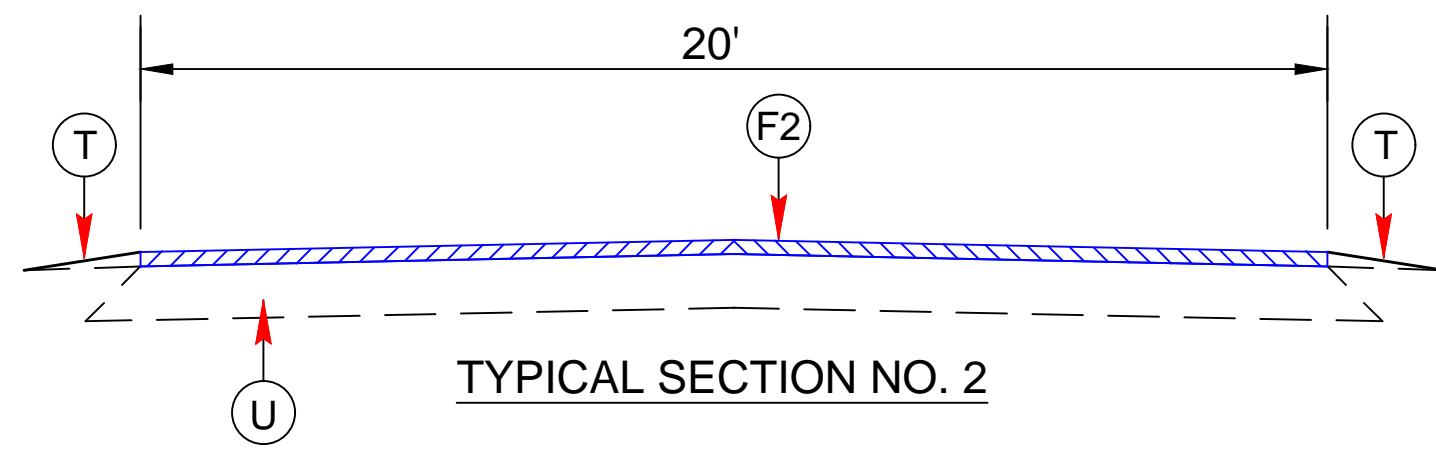
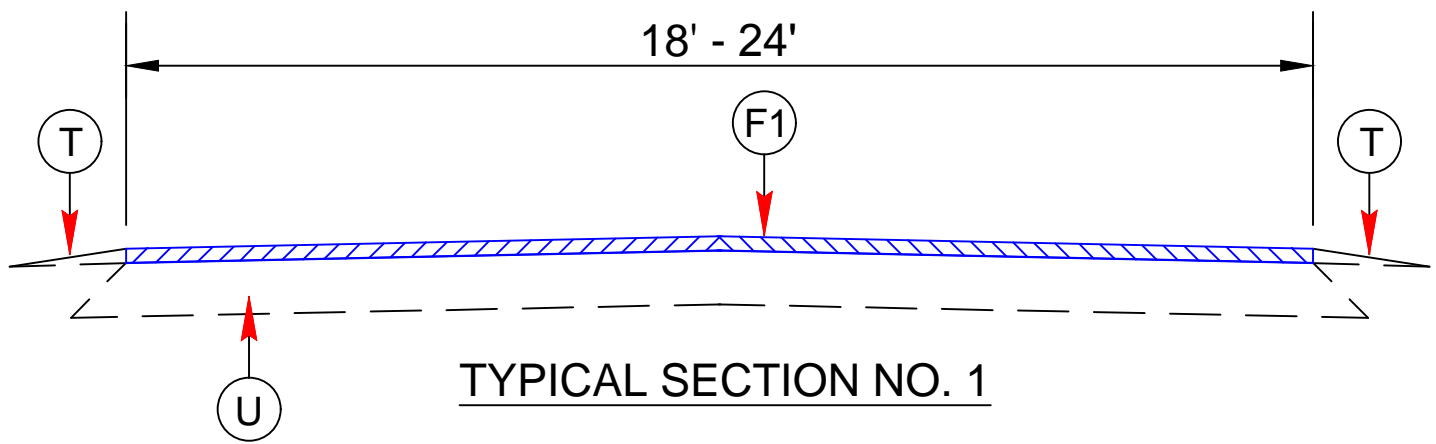

PAVEMENT SCHEDULE	
F1	DOUBLE SEAL PLACED ACCORDING TO THE SPECIAL PROVISIONS
F2	TRIPLE SEAL PLACED ACCORDING TO THE SPECIAL PROVISIONS
T	EXISTING SHOULDER
U	EXISTING ASPHALT

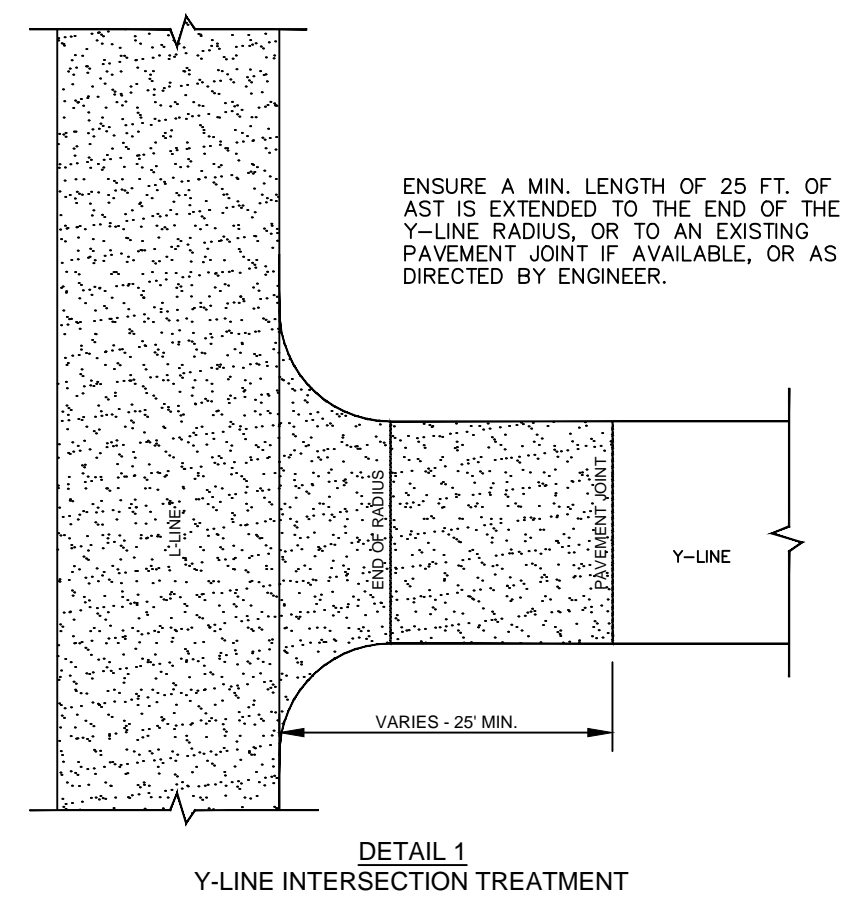

SIGNING FOR ASPHALT SURFACE TREATMENT

LEGEND

- PORTABLE SIGN
- STATIONARY SIGN
- DIRECTION OF TRAFFIC FLOW

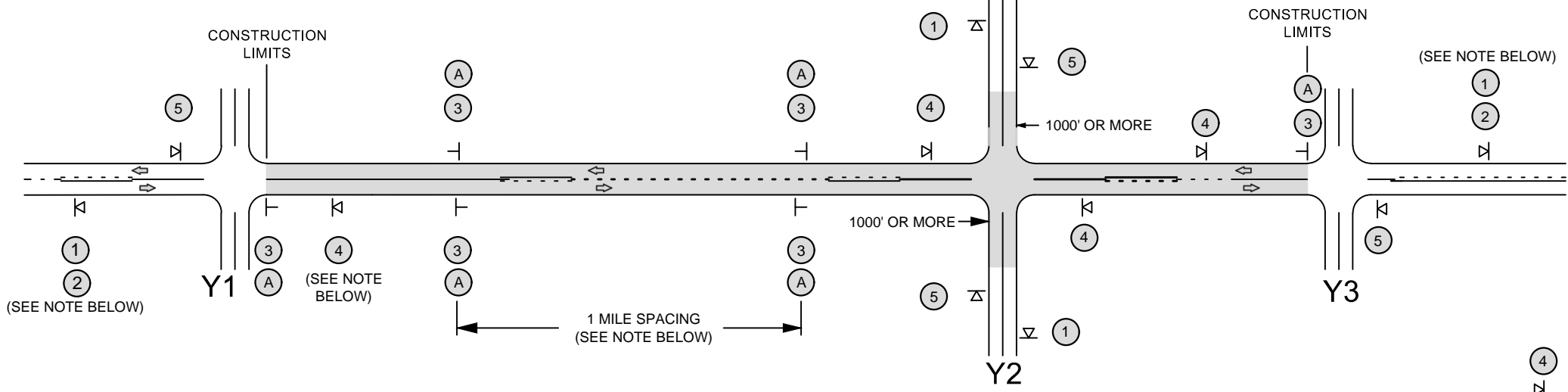

MAINLINE (-L-) SIGNING

-Y- LINE SIGNING

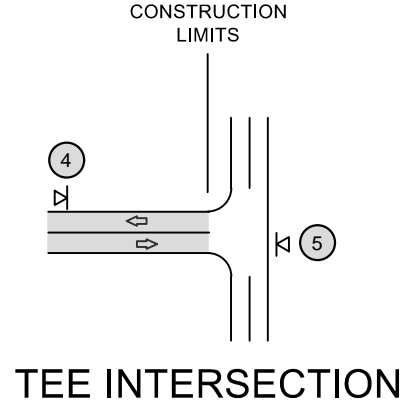

SIGNING NOTES AND PLACEMENT PER DIRECTION	<p>① ROAD WORK AHEAD W20-1 48" X 48"</p> <p>② NEXT XX MILES W7-3aP 24" X 18"</p>	<p>- PLACE 1000' PRIOR TO BEGINNING OF CONSTRUCTION LIMITS. ONLY USED ON -Y- LINES IF RESURFACING LIMITS EXTEND 1000' ALONG -Y- LINE.</p> <p>- SIGN #2 ONLY USED WHEN RESURFACING LIMITS ARE 2 OR MORE MILES IN LENGTH. ROUND UP TO THE NEAREST WHOLE NUMBER. DO NOT USE FRACTIONAL OR DECIMAL NUMBERS.</p>
	<p>③ LOOSE GRAVEL W8-7 48" X 48"</p> <p>UNMARKED PAVEMENT SP 48" X 48"</p>	<p>- ALTERNATE THE FOLLOWING TWO SIGNS:</p> <p>- STARTING WITH "LOOSE GRAVEL" (W8-7) FOLLOWED BY "UNMARKED PAVEMENT".</p> <p>- PLACE INITIALLY AT THE CONSTRUCTION LIMITS AND SPACED 1 MILE APART THEREAFTER.</p> <p>- AT TEE INTERSECTIONS INSTALL INITIALLY 0.5 MILE FROM INTERSECTION AND SPACE 1 MILE APART THEREAFTER.</p>
	<p>A SPEED LIMIT 35 W13-1P 18" X 18"</p>	<p>PLACE INITIALLY AT THE CONSTRUCTION LIMITS AND SPACED 1 MILE APART THEREAFTER. IF NO -Y- LINES EXIST, PLACE 2ND SET 1/2 MILE FROM THE CONSTRUCTION LIMITS AND THEN SPACE 1 MILE THEREAFTER. SPEED LIMIT SIGN MAY BE PLACED ON SAME POST AS LOOSE GRAVEL SIGN, IF DESIRED.</p>
	<p>④ ROAD UNDER CONST SP 13106 48" X 48"</p>	<p>- THESE ARE FOR -Y- LINES THAT ARE "THROUGH" ROADWAYS. DEAD END AND SUBDIVISION ROADS ARE NOT "THROUGH" ROADWAYS.</p> <p>- INSTALL 500' +/- FROM EACH -Y- LINE APPROACH AS SHOWN ABOVE.</p> <p>- FOR MULTIPLE -Y- LINES THAT ARE SEPARATED BY 0.25 MILES OR LESS, TREAT AS A SINGLE UNIT AND INSTALL WITHIN 500' OF EACH APPROACH.</p> <p>- A MAXIMUM OF 2 SIGN SETS PER MILE. DO NOT INSTALL WHEN -Y- LINES ARE WITHIN 0.5 MILES FROM "END ROAD WORK" SIGN.</p>
	<p>⑤ END ROAD WORK G20-2 A 48" X 24"</p>	<p>PLACE 500' FOLLOWING THE END OF CONSTRUCTION LIMITS OR AS SHOWN WHEN WORK ENDS AT A 3-WAY TEE INTERSECTION.</p>

STATIONARY SIGNING NOT REQUIRED FOR THE FOLLOWING -Y- LINE CONDITIONS:

- LESS THAN 1000' OF RESURFACING ALONG -Y- LINE
- SUBDIVISION ROADS
- DEAD END ROADS

WHEN PAVING/CONSTRUCTION ACTIVITIES PROCEED ACROSS AN UNSIGNED -Y- LINE, PORTABLE ADVANCE WARNING SIGNS SHALL BE USED ALONG THE -Y- LINE AS SHOWN BELOW. REMOVE UPON COMPLETION OF WORK.

W20-1 48" X 48"

PLACED 500' IN ADVANCE OF FLAGGER.

W20-7 A 48" X 48"

PLACED 250' IN ADVANCE OF FLAGGER.

NOTE:
IT IS THE CONTRACTOR'S RESPONSIBILITY TO ENSURE THE PROPER PLACEMENT AND LOCATION OF WORK ZONE SIGNING PER THE STANDARD DRAWING. NCDOT HAS THE RIGHT TO INSPECT THE PLANNED LOCATIONS AND REQUIRE ADJUSTMENT BY THE CONTRACTOR, AS NEEDED, OR AS DIRECTED BY THE ENGINEER.

MAPS LESS THAN 2 MILES

FOR AST RESURFACING MAPS WITH CONSTRUCTION LIMITS LESS THAN 2 MILES IN LENGTH, USE A STATIONARY "LOOSE GRAVEL" SIGN AT THE BEGINNING CONSTRUCTION LIMIT FOLLOWED BY AN "UNMARKED PAVEMENT" SIGN MIDWAY THROUGH AND AN "END ROAD WORK" SIGN AT THE END CONSTRUCTION LIMIT.

REVISED - 12-13-2018

NCDOT - DIVISION 6

ADVANCE WARNING SIGNS FOR 2-LANE ROADWAY ASPHALT SURFACE TREATMENT

